

The design on this drawing remains the property of the architect - Copyright Reserved - All dimensions to be checked on site before work in hand. Any discrepancy must be immediately reported to the architect. Die ontwerp op hierdie tekening bly die eienaar se eiendom. Al die afmetings moet op die terrein nagegaan word voor enige werk begin word. Enige fout moet onmiddellik aan die argitek geseël word. Die ontwerp op hierdie tekening bly die argitek se eiendom. Al die afmetings moet op die terrein nagegaan word voor enige werk begin word. Enige fout moet onmiddellik aan die argitek geseël word.

- OPEN PARKING
2.7 x 5.0m
- GATE PARKING
2.7 x 5.0m
- COVERED PARKING
2.7 x 5.0m
- DISABLED PARKING
3.7 x 5.0m
- FLOOR LEVEL
- EXISTING TREE REMOVED
- EXISTING TREE REMAINING
- NEW TREE

DETAILS TO BE CLARIFIED ON LANDSCAPE PLAN
ROADWAYS & PARKING TO BE CONCRETE INTERLOCKING PAVERS, WITH ROADWAY PARKING MARKERS PAINTED ON.

Section 16 No R 2258/1992
EROM SERVITUDE TO BE CANCELLED

ErF 2635 rem

Portion 3 Erf 2635

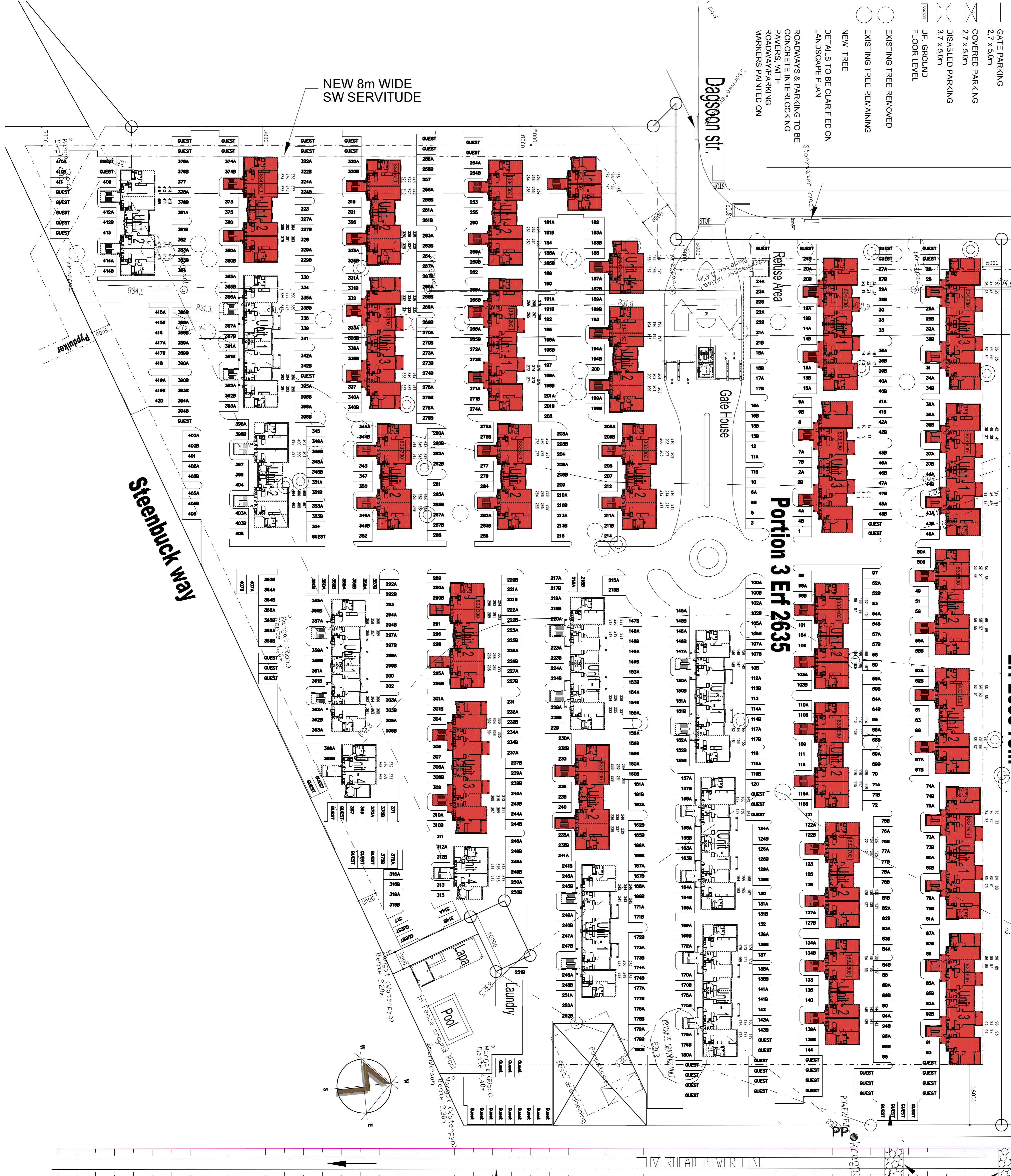

STONE PITCHING/
CONC BLOCKS
FOR EROSION
PREVENTION
AS PER DETAIL

SW CONN FOR
ERF 1/2635
DEPTH 2,16m

PROPOSED
CANAL
Onverwacht way

SKETCHPLAN - EXTENDED SITE - 1/500

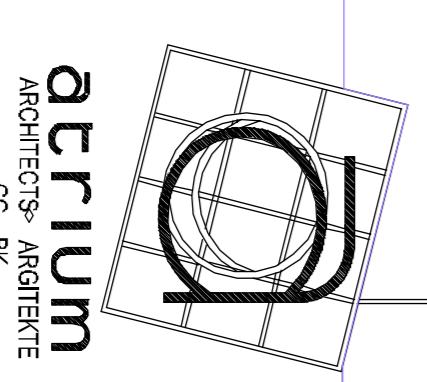

Suite 2, SELATI PARK
PO BOX 55842
PHEUNU PARK
0102
TEL: (012) 460-1776/7
FAX: (012) 460-4059
SHINEHLING (REG NO. 2977)
WJ DE KLERK (REG NO. 50589)
(REG NO. 1995/06754/233)

Project title/Project title
SECTIONAL TITLE FLATS FOR
UNION WINGS ON ERF 2635
ELL SRAS 1.6
Skaal/Scale:
1:500
Datum/Date:
2008/4/27
Getekend/Drawn:
TEKENINGSOMMER
PROEJENOMMER
2008/4/27 R0 SI 001

Project title/Project title
SECTIONAL TITLE FLATS FOR
UNION WINGS ON ERF 2635
ELL SRAS 1.6
Skaal/Scale:
1:500
Datum/Date:
2008/4/27
Getekend/Drawn:
TEKENINGSOMMER
PROEJENOMMER
2008/4/27 R0 SI 001